

October 2011

SAN DIEGO
MESA COLLEGE

MESA NEWS

WELCOME TO MESA E-NEWS, the monthly e-zine of college-wide events, activities and news. Go to www.sdmesa.edu/e-news/index.html for more information on the following October 2011 items:

NEWS and EVENTS at SAN DIEGO MESA COLLEGE

ANNOUNCING... The Bright Idea Program

www.facebook.com/sandiegomesacollege

President Pam Luster had a bright idea... and this month launches the "Bright Idea Program." Intended to capture the best ideas of staff and to help create better processes and services for students and the college, the program aims to make Mesa College more efficient through tapping into the expertise of people closest to the work. A special award will be given each semester to recognize an individual or group who has suggested an idea, procedure or program that, when implemented, will result in improved operations. Recipients must be permanent classified employees, including supervisors, who submit an idea that improves cost-effectiveness, safety or convenience; promotes sustainability; and/or solves a problem on campus. As important, the idea must support the implementation of the idea in a manner consistent with department procedures and a spirit of promoting collaboration among students, faculty, staff and community members. This fall's winner(s) will receive a minimum of two and up to five tickets for a Hornblower Cruise on San Diego Bay (the tickets were donated). Deadline for submissions is October 21, 2011. See the DL from Sara Beth Cain with full details on how to submit your bright idea!

Math+Science Building = Future/Innovation • Excellence

Before a crowd of approximately 200 students, faculty, staff and special guests, a ceremonial groundbreaking was held Wednesday to mark construction of the future Math+Science Complex at San Diego Mesa College, the largest teaching and learning facility to be built on the campus and within the entire SDCCD at 206,000 gross square feet. "When you think of the vast changes going on in terms of science and the mathematics that will support these and other fields, one can only imagine the kind of education our students will be able to receive in this fabulous new building," said President Pamela T. Luster. "We will have state-of-the-art labs, state-of-the-art classrooms, and instructors who will be able to live out their lifelong dreams of teaching in a facility they helped to create." Faculty members, many of whom have spent years working with the design team on instructional programming needs, praised the design for promoting learning inside and outside of classrooms and laboratories. "I think what we're going to have here in a couple of years is a building that shows that science and mathematics education is vital, valued, and contemporary at Mesa College," said Chemistry Professor Donna Budzynski, co-chair of the planning committee. For photos, see: www.facebook.com/sandiegomesacollege.



SAN DIEGO COMMUNITY COLLEGE DISTRICT

CITY COLLEGE • MESA COLLEGE • MIRAMAR COLLEGE • CONTINUING EDUCATION

A Walk in the Park in Support of AIDS Research

Twenty people joined Team Mesa for the 2011 AIDS WALK AND RUN on Sunday, Sept. 25 at Balboa Park, including students, ambassadors, Classified Staff and family members. The Mesa Team was organized by Student Health Services to support the largest one-day HIV/AIDS Fundraiser in San Diego County. Mesa has been represented at the walk for more than six years. "Every single person makes a difference; and bit of money adds a lot," said organizer Polly Rose. There's still time to make a contribution; if you'd like to make a donation, [contact Polly](#).



Sign-Off on the Social/Behavioral Sciences Building

On Friday, Sept. 30, the Dean Charles Zappia and faculty from the School of Social/Behavioral Sciences and Multicultural Studies "signed off" in approval of the Schematic Design Plan for the next instructional building to be built at Mesa College. The three-story building, which will define the eastern perimeter of a new central campus quadrangle, will house the departments of Anthropology, Psychology, Sociology, History, Geography, Philosophy and Political Science. The new facility will open to the campus community in the Fall of 2014.



Quad Dreams...

Planning for the new Mesa College Quad has begun! In a few years, a new Mesa College quadrangle will fill 3.8 acres in the center of the campus. (For comparison, a football field, including the end zones, covers approximately 1.32 acres.) What should the new quad (or quads) look like? What venues should it accommodate -- quiet learning spaces, major events, performance amphitheatres? What about kiosks, Wi-Fi, and hydration stations? How will it reflect and be used by our students, and reflect the college's culture and diversity? All of these questions and more are being considered, and we want your voice to be heard. Please join in the conversation with representatives from renown landscape architects, The Office of James Barnett. The second in a series of workshops is being held Oct. 19 or 20. [Click here to link to the flyer.](#) (NOTE: New dates and location!)

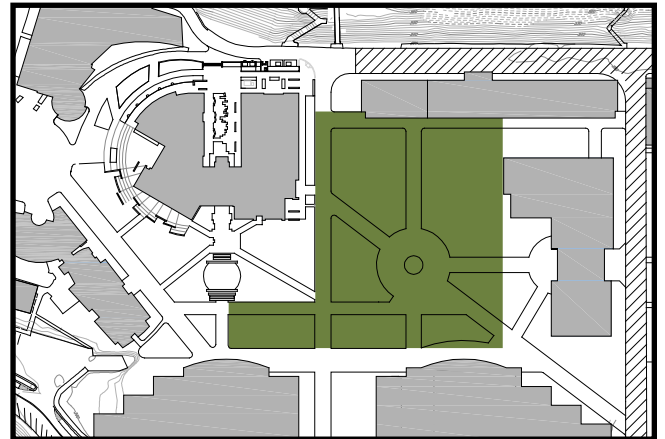

On-Track with the Olympians!

The Olympians athletic teams have been performing well so far this season. The women's soccer team has already made a strong showing with a 6-2-2 overall record and is currently second place in the Pacific Coast Athletic Conference behind Miramar College. The men's team has had a rough start but they are improving and have plenty of time to make their mark in the conference standings. • The Mesa Volleyball squad is back on track despite some serious injuries to key players. The rest of the women's team was able to fill in for their teammates and pull off a few wins to improve their season standing to 6-5 with their first PCAC win of the season over City College. • At Douglas Stadium, the Mesa Football team celebrated their home opener with a win over powerhouse Grossmont College. This marks the first victory for the Olympians over the Griffins since 1993. The team has faced some tough opponents since that win and is looking forward to being in the top of the American Mountain Conference which will start October 15 at East Los Angeles College. • Both the men

and women's cross country teams did well in their races at Balboa Park at the Aztec Invitational. This race is primarily for competitors at the four-year college level and our Olympian runners managed to stay in the race to the finish line. • In the pool, both water polo teams have been fighting it out with the top teams in the conference. The women were able to move into the third spot in the conference following their victory over Miramar giving them a 2-2 record in the PCAC and 6-5 overall. Their male counterparts are also holding their position in third with a matching 2-2 conference record and are 9-7 overall. **For athletics calendar, please see the online campus calendar or go to <http://www.sdmesa.edu/athletics/index.cfm>.**

Olympians on the Move

PROMOTIONS:

- **Johanna Bodnar**, Student Services Asst, DSPS/EOPS, Reclass to Sr. SSA
- **Smith, Sharon** (Nikki), Accounting Technician, Student Accounting, Reclass to Sr. Acct Tech.

RECLASSIFICATIONS:

- **Asress Ephrem**, Sr. Account Clerk, Student Accounting, Reclass to Accounting Technician.

TRANSFERS:

- **Cesar Ochoa**, Accounting Technician, Business Services, Transfer from District

Passings

Jerry Schad. It is with great sadness to note the passing of Mesa College's longtime colleague and friend, Professor Jerry Schad. Jerry, who was diagnosed with kidney cancer last year, died on Thursday, Sept. 22. Dean Saeid Eidgahy recalls that Jerry's tenure at San Diego Mesa College dated back to 1975 when he first began as an adjunct faculty member. He became a full-time professor at Mesa College in 1989 and was elected the Chair of the Department of Physical Sciences in 1999; a critical leadership position he served with distinction through this past academic year. He earned degrees from UC Berkeley and San Diego State University in Astronomy prior to beginning his almost 3-1/2 decades of teaching at Mesa. During that time, Jerry mentored literally thousands of students and left an inquisitive mark on anyone with whom he interacted. As an educator, author of many books, a hiker and naturalist, a world class photographer and traveler; he garnered professional admiration and friends everywhere. Memorial Service will be held: 4 p.m., Sunday, Oct. 9 at El Cortez in San Diego.



THE MONTH AHEAD: October

You can always check out what's happening at www.sdmesa.edu/events or This Month at Mesa at <http://www.sdmesa.edu/news/month.cfm>

- **The Mesa College Music Showcase at Dizzy's** (off campus). Featuring performances by the Mesa College Vocal Ensemble, the Jazz Band, and faculty members Bob Boss, Jaeryoung Lee, Bob Magnusson, James Romeo, and George Svoboda, plus a composition by Momilani Ramstrum. Dizzy's, located at the beautiful San Diego Wine and Culinary Center, Harbor Club Towers ground floor, 2nd and J St. \$10 at the door. Come early for a good seat.
- The Physical Education Department invites you to a **Retirement Party for Sue Lalicker, Jerry Milburn and Arnie Robinson**. Sun., Oct. 23, 4:00 to 6:00 p.m., Pacific Beach Woman's Club 1721 Hornblend, San Diego. Please RSVP by Oct. 14, 2011 to Tricia R. Mendoza, tmendoza@sdccd.edu. \$20 per person.
- **Program Review Lead Writer Training:** Fri., Oct. 7 from 11 a.m. to 1:00 p.m. in G-101. RSVP to Monica Romero at 619-388-2781.

STAY INFORMED

- **Prop S&N Updates** are posted to VP Ron Perez's monthly reports at <http://sdmesa.edu/parking/>
- **Shared governance** committee agendas, minutes and reports can be found at <http://www.sdmesa.edu/governance/committees>.

Mesa eNews is published by Mesa College Communications Services. To add information items, e-mail lheil@sdccd.edu. Be sure to provide all specifics, and please limit your copy to 75 words or less.

Thank you!